

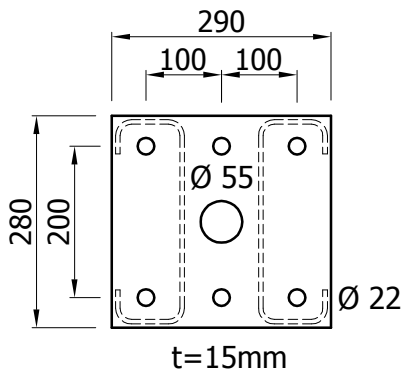

MegaSteel Profile MS-A

Données techniques	
Max. capacité	1000 kN
Qualité de l'acier	S355
Aire de la section	5`845mm ²
I _x	59.8 x 10 ⁶ mm ⁴
I _y	42.9 x 10 ⁶ mm ⁴
Poids propre	~0.6 kN/m`

Plaque de base



Section

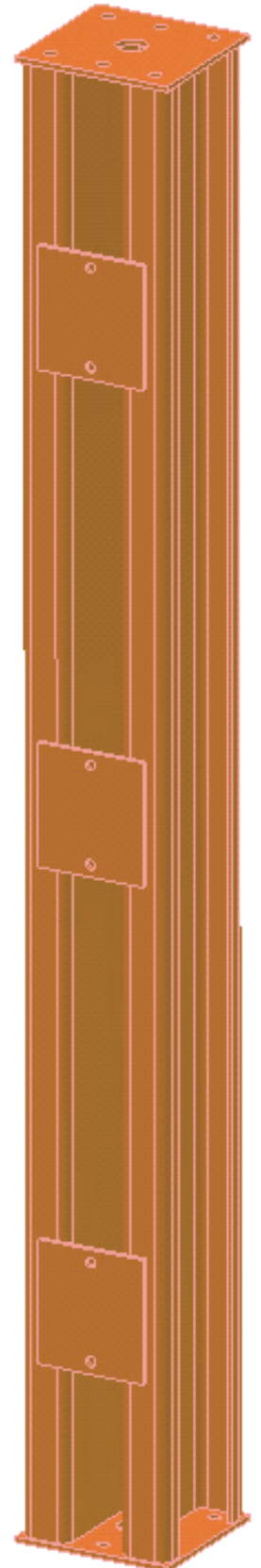
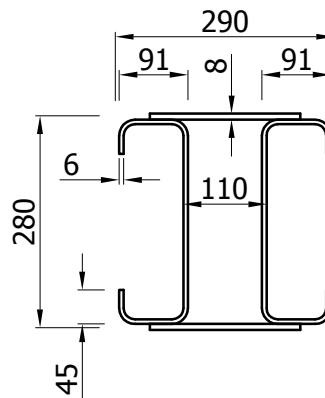

Excentricité	Charge admissible* N (kN)							
	Longueur effective L							
	1m	3m	5m	7m	9m	12m	15m	18m
e=10	1000	980	800	570	380	260	210	170
e=25	860	780	650	470	330	230	180	160
e=50	650	600	500	370	280	210	170	150

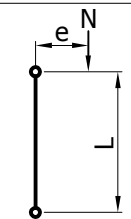

* avec un coefficient de 1.5 prise en considération